

**Collari serie pesante
in polipropilene,
poliammide autoestinguente,
alluminio o gomma**

**Heavy duty clamps
in polypropylene,
self-extinguishing polyamide,
aluminium or rubber**

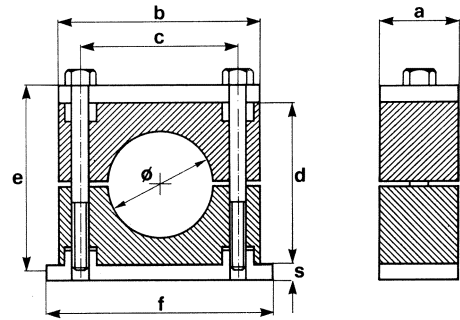

gruppo - group	diametro tubo pipe diameter			tipo di collare clamp type				dimensioni in mm dimension in mm						
	Ø mm	pollici / inches G	Ø O.D.	AMP.P polipropilene polypropylene	MMP.P poliammide self-extinguishing	RMP.P gomma rubber	AMLL.P alluminio aluminium	a	b	c	d	f	s	e
1	6			AMP.P ₁ 06	MMP.P ₁ 06	RMP.P ₁ 06	AMLL.P ₁ 06	30	55	33	32	73	8	M10x45
	6,4		1/4"	AMP.P ₁ 6,4	MMP.P ₁ 6,4	RMP.P ₁ 6,4	AMLL.P ₁ 6,4							
	8		5/16"	AMP.P ₁ 08	MMP.P ₁ 08	RMP.P ₁ 08	AMLL.P ₁ 08							
	9,5		3/8"	AMP.P ₁ 9,5	MMP.P ₁ 9,5	RMP.P ₁ 9,5	AMLL.P ₁ 9,5							
	10	1/8"		AMP.P ₁ 10	MMP.P ₁ 10	RMP.P ₁ 10	AMLL.P ₁ 10							
	12			AMP.P ₁ 12	MMP.P ₁ 12	RMP.P ₁ 12	AMLL.P ₁ 12							
	12,7		1/2"	AMP.P ₁ 12,7	MMP.P ₁ 12,7	RMP.P ₁ 12,7	AMLL.P ₁ 12,7							
	13,5	1/4"		AMP.P ₁ 1/4"	MMP.P ₁ 1/4"	RMP.P ₁ 1/4"	AMLL.P ₁ 1/4"							
	14			AMP.P ₁ 14	MMP.P ₁ 14	RMP.P ₁ 14	AMLL.P ₁ 14							
	15			AMP.P ₁ 15	MMP.P ₁ 15	RMP.P ₁ 15	AMLL.P ₁ 15							
2	16		5/8"	AMP.P ₁ 16	MMP.P ₁ 16	RMP.P ₁ 16	AMLL.P ₁ 16	30	70	45	48	85	8	M10x60
	17,2	3/8"		AMP.P ₁ 3/8"	MMP.P ₁ 3/8"	RMP.P ₁ 3/8"	AMLL.P ₁ 3/8"							
	18			AMP.P ₁ 18	MMP.P ₁ 18	RMP.P ₁ 18	AMLL.P ₁ 18							
	19		3/4"	AMP.P ₂ 19	MMP.P ₂ 19	RMP.P ₂ 19	AMLL.P ₂ 19							
	20			AMP.P ₂ 20	MMP.P ₂ 20	RMP.P ₂ 20	AMLL.P ₂ 20							
	21,3	1/2"		AMP.P ₂ 1/2"	MMP.P ₂ 1/2"	RMP.P ₂ 1/2"	AMLL.P ₂ 1/2"							
	22		7/8"	AMP.P ₂ 22	MMP.P ₂ 22	RMP.P ₂ 22	AMLL.P ₂ 22							
	25			AMP.P ₂ 25	MMP.P ₂ 25	RMP.P ₂ 25	AMLL.P ₂ 25							
	25,4		1"	AMP.P ₂ 25,4	MMP.P ₂ 25,4	RMP.P ₂ 25,4	AMLL.P ₂ 25,4							
	26,9	3/4"		AMP.P ₂ 3/4"	MMP.P ₂ 3/4"	RMP.P ₂ 3/4"	AMLL.P ₂ 3/4"							
3	28			AMP.P ₂ 28	MMP.P ₂ 28	RMP.P ₂ 28	AMLL.P ₂ 28	30	85	60	60	102	8	M10x70
	30			AMP.P ₂ 30	MMP.P ₂ 30	RMP.P ₂ 30	AMLL.P ₂ 30							
	30			AMP.P ₃ 30	MMP.P ₃ 30	RMP.P ₃ 30	AMLL.P ₃ 30							
	32		1 1/4"	AMP.P ₃ 32	MMP.P ₃ 32	RMP.P ₃ 32	AMLL.P ₃ 32							
	33,7	1"		AMP.P ₃ 1"	MMP.P ₃ 1"	RMP.P ₃ 1"	AMLL.P ₃ 1"							
	35			AMP.P ₃ 35	MMP.P ₃ 35	RMP.P ₃ 35	AMLL.P ₃ 35							
	38		1 1/2"	AMP.P ₃ 38	MMP.P ₃ 38	RMP.P ₃ 38	AMLL.P ₃ 38							
4	40			AMP.P ₃ 40	MMP.P ₃ 40	RMP.P ₃ 40	AMLL.P ₃ 40	45	120	90	90	140	10	M12x100
	42			AMP.P ₃ 42	MMP.P ₃ 42	RMP.P ₃ 42	AMLL.P ₃ 42							
	42,4	1 1/4"		AMP.P ₃ 1 1/4"	MMP.P ₃ 1 1/4"	RMP.P ₃ 1 1/4"	AMLL.P ₃ 1 1/4"							
	44,5		1 3/4"	AMP.P ₄ 44,5	MMP.P ₄ 44,5	RMP.P ₄ 44,5	AMLL.P ₄ 44,5							
	48,3	1 1/2"		AMP.P ₄ 1 1/2"	MMP.P ₄ 1 1/2"	RMP.P ₄ 1 1/2"	AMLL.P ₄ 1 1/2"							
	50			AMP.P ₄ 50	MMP.P ₄ 50	RMP.P ₄ 50	AMLL.P ₄ 50							
	50,8		2"	AMP.P ₄ 50,8	MMP.P ₄ 50,8	RMP.P ₄ 50,8	AMLL.P ₄ 50,8							
	55			AMP.P ₄ 55	MMP.P ₄ 55	RMP.P ₄ 55	AMLL.P ₄ 55							
	57		2 1/4"	AMP.P ₄ 57	MMP.P ₄ 57	RMP.P ₄ 57	AMLL.P ₄ 57							
	60,3	2"		AMP.P ₄ 2"	MMP.P ₄ 2"	RMP.P ₄ 2"	AMLL.P ₄ 2"							
	63,5		2 1/2"	AMP.P ₄ 63,5	MMP.P ₄ 63,5	RMP.P ₄ 63,5	AMLL.P ₄ 63,5							
65			AMP.P ₄ 65	MMP.P ₄ 65	RMP.P ₄ 65	AMLL.P ₄ 65								
70		2 3/4"	AMP.P ₄ 70	MMP.P ₄ 70	RMP.P ₄ 70	AMLL.P ₄ 70								

AMP.P*... = polipropilene / polypropylene
 ...H = interno liscio / smooth inside (per ordine di collari tipo H, aggiungere H dopo il codice / to order clamps type H, please put the H at the end of the code)

MMP.P... = polyamide / self-extinguishing

RMP.P... = gomma / rubber

AMLL.P... = alluminio / aluminium

tipo normale
interno sagomato

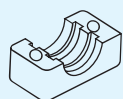

normal model
profiled inside

tipo H
interno liscio

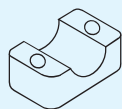

H model
smooth inside

tipo normale
interno sagomato

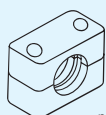

normal model
profiled inside

tipo H
interno liscio

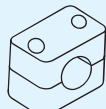

H model
smooth inside

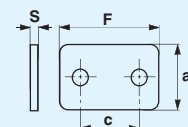
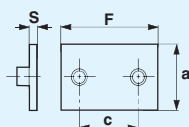

semi-collare clamp-half	coppia collari clamp body (2 halves)	piastra inferiore lower plate				piastra superiore upper plate			
		APINP				APSP			
AMP.P ... S	AMP.P ... C	a mm	F mm	c mm	S mm	a mm	F mm	c mm	S mm
AMP.P ₁ 06 S	AMP.P ₁ 06 C	APINP₁				APSP₁			
AMP.P ₁ 6,4 S	AMP.P ₁ 6,4 C	30	75	33	8	30	55	33	8
AMP.P ₁ 08 S	AMP.P ₁ 08 C								
AMP.P ₁ 9,5 S	AMP.P ₁ 9,5 C								
AMP.P ₁ 10 S	AMP.P ₁ 10 C								
AMP.P ₁ 12 S	AMP.P ₁ 12 C								
AMP.P ₁ 12,7 S	AMP.P ₁ 12,7 C								
AMP.P ₁ 1/4" S	AMP.P ₁ 1/4" C								
AMP.P ₁ 14 S	AMP.P ₁ 14 C								
AMP.P ₁ 15 S	AMP.P ₁ 15 C								
AMP.P ₁ 16 S	AMP.P ₁ 16 C								
AMP.P ₁ 3/8" S	AMP.P ₁ 3/8" C								
AMP.P ₁ 18 S	AMP.P ₁ 18 C								
AMP.P ₂ 19 S	AMP.P ₂ 19 C	APINP₂				APSP₂			
AMP.P ₂ 20 S	AMP.P ₂ 20 C	30	87	45	8	30	70	45	8
AMP.P ₂ 1/2" S	AMP.P ₂ 1/2" C								
AMP.P ₂ 22 S	AMP.P ₂ 22 C								
AMP.P ₂ 25 S	AMP.P ₂ 25 C								
AMP.P ₂ 25,4 S	AMP.P ₂ 25,4 C								
AMP.P ₂ 3/4" S	AMP.P ₂ 3/4" C								
AMP.P ₂ 28 S	AMP.P ₂ 28 C								
AMP.P ₂ 30 S	AMP.P ₂ 30 C								
AMP.P ₃ 30 S	AMP.P ₃ 30 C	APINP₃				APSP₃			
AMP.P ₃ 32 S	AMP.P ₃ 32 C	30	102	60	8	30	85	60	8
AMP.P ₃ 1" S	AMP.P ₃ 1" C								
AMP.P ₃ 35 S	AMP.P ₃ 35 C								
AMP.P ₃ 38 S	AMP.P ₃ 38 C								
AMP.P ₃ 40 S	AMP.P ₃ 40 C								
AMP.P ₃ 42 S	AMP.P ₃ 42 C								
AMP.P ₃ 1 1/4" S	AMP.P ₃ 1 1/4" C								
AMP.P ₄ 38 S	AMP.P ₄ 38 C	APINP₄				APSP₄			
AMP.P ₄ 42 S	AMP.P ₄ 42 C	45	140	90	10	45	120	90	10
AMP.P ₄ 1 1/4" S	AMP.P ₄ 1 1/4" C								
AMP.P ₄ 44,5 S	AMP.P ₄ 44,5 C								
AMP.P ₄ 1 1/2" S	AMP.P ₄ 1 1/2" C								
AMP.P ₄ 50 S	AMP.P ₄ 50 C								
AMP.P ₄ 50,8 S	AMP.P ₄ 50,8 C								
AMP.P ₄ 55 S	AMP.P ₄ 55 C								
AMP.P ₄ 57 S	AMP.P ₄ 57 C								
AMP.P ₄ 2" S	AMP.P ₄ 2" C								
AMP.P ₄ 63,5 S	AMP.P ₄ 63,5 C								
AMP.P ₄ 65 S	AMP.P ₄ 65 C								
AMP.P ₄ 70 S	AMP.P ₄ 70 C								

* La produzione standard è di colore verde, colore nero su richiesta.
 Standard production in green, black color on request.

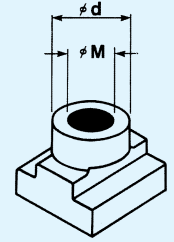
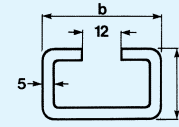
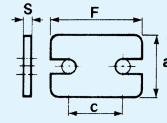
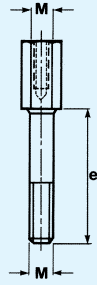
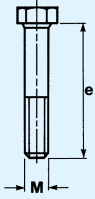

vite a testa esagonale hexagonal head screw	vite a testa esagonale allungata high hexagonal head screw	piastra superiore di sicurezza security upper plate				binari portanti spessore 5 mm rail		dado fissaggio binari rail nut		
AVTEP	AVTEAP	APMRSP				ABINP		ADESP		
M e mm	M e mm	a mm	F mm	c mm	S mm	b mm	h mm	M	Ø d mm	
AVTEP₁	AVTEAP₁	APMRSP₁				ABINP-1	40	22	ADESP-1	
M10 45	M10 26	30	55	33	8				M10 18	
AVTEP₂	AVTEAP₂	APMRSP₂							ADESP-2	
M10 60	M10 41	30	70	45	8					M12 20
AVTEP₃	AVTEAP₃	APMRSP₃								
M10 70	M10 52	30	85	60	8					
AVTEP₄	AVTEAP₄	APMRSP₄								
M12 100	M12 83	45	120	90	10					

* Altre piastre speciali sono a pag. 19
Other special plate are at page 19

**Collari serie pesante
in polipropilene,
poliammide autoestinguente,
alluminio o gomma**

**Heavy duty clamps
in polypropylene,
self-extinguishing polyamide,
aluminium or rubber**

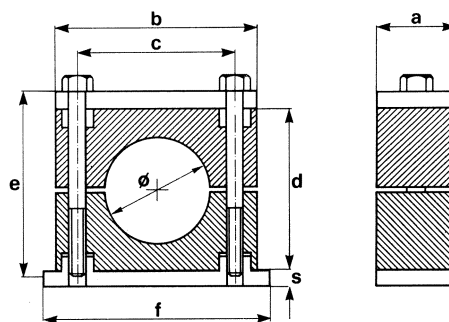

gruppo - group	diametro tubo pipe diameter			tipo di collare clamp type				dimensioni in mm dimension in mm						
	Ø mm	pollici/inches G	Ø O.D.	AMP.P polipropilene polypropylene	MMP.P polyamide self-extinguishing	RMP.P gomma rubber	AMLL.P alluminio aluminium	a	b	c	d	f	s	e
5	65			AMP.P ₅ 65	MMP.P ₅ 65	RMP.P ₅ 65	AMLL.P ₅ 65	60	152	122	120	180	10	M16x130
	70		2 ³ / ₄ "	AMP.P ₅ 70	MMP.P ₅ 70	RMP.P ₅ 70	AMLL.P ₅ 70							
	75			AMP.P ₅ 75	MMP.P ₅ 75	RMP.P ₅ 75	AMLL.P ₅ 75							
	76,1	2 ¹ / ₂ "	3"	AMP.P ₅ 2 ¹ / ₂ "	MMP.P ₅ 2 ¹ / ₂ "	RMP.P ₅ 2 ¹ / ₂ "	AMLL.P ₅ 2 ¹ / ₂ "							
	80			AMP.P ₅ 80	MMP.P ₅ 80	RMP.P ₅ 80	AMLL.P ₅ 80							
	82,5		3 ¹ / ₄ "	AMP.P ₅ 82,5	MMP.P ₅ 82,5	RMP.P ₅ 82,5	AMLL.P ₅ 82,5							
	88,9	3"	3 ¹ / ₂ "	AMP.P ₅ 3"	MMP.P ₅ 3"	RMP.P ₅ 3"	AMLL.P ₅ 3"							
6	88,9	3"	3 ¹ / ₂ "	AMP.P ₆ 3"	MMP.P ₆ 3"	RMP.P ₆ 3"	-	80	205	168	170	225	15	M20x190
	100			AMP.P ₆ 100	MMP.P ₆ 100	RMP.P ₆ 100	-							
	101,6	3 ¹ / ₂ "	4"	AMP.P ₆ 3 ¹ / ₂ "	MMP.P ₆ 3 ¹ / ₂ "	RMP.P ₆ 3 ¹ / ₂ "	-							
	108		4 ¹ / ₄ "	AMP.P ₆ 108	MMP.P ₆ 108	RMP.P ₆ 108	-							
	114,3	4"	4 ¹ / ₂ "	AMP.P ₆ 4"	MMP.P ₆ 4"	RMP.P ₆ 4"	-							
	127	4 ¹ / ₂ "	5"	AMP.P ₆ 4 ¹ / ₂ "	MMP.P ₆ 4 ¹ / ₂ "	RMP.P ₆ 4 ¹ / ₂ "	-							
	133		5 ¹ / ₂ "	AMP.P ₆ 133	MMP.P ₆ 133	RMP.P ₆ 133	-							
7	133		5 ¹ / ₄ "	AMP.P ₇ 133	MMP.P ₇ 133	RMP.P ₇ 133	-	90	250	205	200	270	15	M24x220
	139,7	5"	5 ¹ / ₂ "	AMP.P ₇ 5"	MMP.P ₇ 5"	RMP.P ₇ 5"	-							
	152,4	5 ¹ / ₂ "	6"	AMP.P ₇ 5 ¹ / ₂ "	MMP.P ₇ 5 ¹ / ₂ "	RMP.P ₇ 5 ¹ / ₂ "	-							
	165		6 ¹ / ₂ "	AMP.P ₇ 165	MMP.P ₇ 165	RMP.P ₇ 165	-							
	168,3	6"		AMP.P ₇ 6"	MMP.P ₇ 6"	RMP.P ₇ 6"	-							
8	168,3	6"		AMP.P ₈ 6"	-	-	-	120	320	265	270	340	25	M30x300
	177,8		7"	AMP.P ₈ 177,8	-	-	-							
	193,7		7 ⁵ / ₈ "	AMP.P ₈ 193,7	-	-	-							
	216		8 ¹ / ₂ "	AMP.P ₈ 216	-	-	-							
	219,1	8"		AMP.P ₈ 8"	-	-	-							

AMP.P*... = polipropilene / polypropylene MMP.P... = polyamide / self-extinguishing RMP.P... = gomma / rubber AMLL.P... = alluminio / aluminium
 ...H = interno liscio / smooth inside (per ordine di collari tipo H, aggiungere H dopo il codice / to order clamps type H, please put the H at the end of the code)

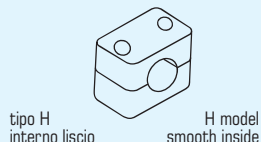
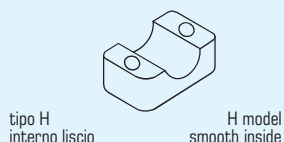
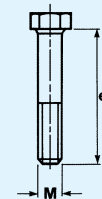
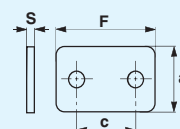
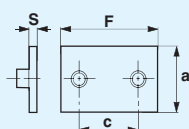
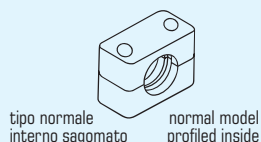
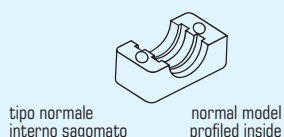

semi-collare clamp-half	coppia collari clamp body (2 halves)	piastra inferiore lower plate				piastra superiore upper plate				vite a testa esagonale hexagonal head screw	
		APINP				APSP				AVTEP	
AMP.P ... S	AMP.P ... C	a mm	F mm	c mm	S mm	a mm	F mm	c mm	S mm	M	e mm
		APINP₅				APSP₅				AVTEP₅	
AMP.P ₅ 65 S	AMP.P ₅ 65 C	60	180	122	10	60	152	122	10	M16	130
AMP.P ₅ 70 S	AMP.P ₅ 70 C										
AMP.P ₅ 75 S	AMP.P ₅ 75 C										
AMP.P ₅ 2 1/2" S	AMP.P ₅ 2 1/2" C										
AMP.P ₅ 80 S	AMP.P ₅ 80 C										
AMP.P ₅ 82,5 S	AMP.P ₅ 82,5 C										
AMP.P ₅ 3" S	AMP.P ₅ 3" C										
		APINP₆				APSP₆				AVTEP₆	
AMP.P ₆ 3" S	AMP.P ₆ 3" C	80	225	168	15	80	205	168	15	M20	190
AMP.P ₆ 100 S	AMP.P ₆ 100 C										
AMP.P ₆ 3 1/2" S	AMP.P ₆ 3 1/2" C										
AMP.P ₆ 108 S	AMP.P ₆ 108 C										
AMP.P ₆ 4" S	AMP.P ₆ 4" C										
AMP.P ₆ 4 1/2" S	AMP.P ₆ 4 1/2" C										
AMP.P ₆ 133 S	AMP.P ₆ 133 C										
		APINP₇				APSP₇				AVTEP₇	
AMP.P ₇ 133 S	AMP.P ₇ 133 C	90	270	205	15	90	250	205	15	M24	220
AMP.P ₇ 5" S	AMP.P ₇ 5" C										
AMP.P ₇ 5 1/2" S	AMP.P ₇ 5 1/2" C										
AMP.P ₇ 165 S	AMP.P ₇ 165 C										
AMP.P ₇ 6" S	AMP.P ₇ 6" C										
		APINP₈				APSP₈				AVTEP₈	
AMP.P ₈ 6" S	AMP.P ₈ 6" C	120	340	265	25	120	320	265	25	M30	300
AMP.P ₈ 177,8 S	AMP.P ₈ 177,8 C										
AMP.P ₈ 193,7 S	AMP.P ₈ 193,7 C										
AMP.P ₈ 216 S	AMP.P ₈ 216 C										
AMP.P ₈ 8" S	AMP.P ₈ 8" C										

* La produzione standard è di colore verde, colore nero su richiesta.
 Standard production in green, black color on request.

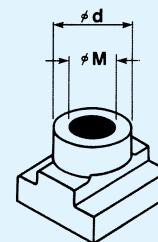
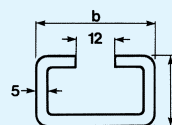
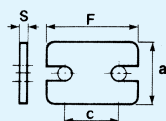
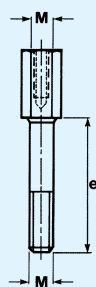

vite a testa esagonale allungata high hexagonal head screw	piastra superiore di sicurezza security upper plate				binari portanti spessore 5 mm rail	dado fissaggio binari rail nut
AVTEAP	APMRSP				ABINP	ADESP
M e mm	a mm	F mm	c mm	S mm	b mm h mm	M Ø d mm
AVTEAP₅	APMRSP₅					
M16 110	60	152	122	10	40 22	M16 20

Piastre doppie per serie pesante Double plates for heavy duty series

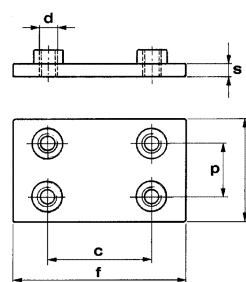
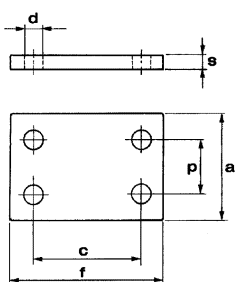

gruppo - group	piastra superiore doppia double upper plate					
	APSPD					
	a mm	f mm	s mm	c mm	p mm	d mm
1	APSPD₁					
	60	56	8	33	31	11
2	APSPD₂					
	60	70	8	45	31	11
3	APSPD₃					
	60	85	8	60	31	11
4	APSPD₄					
	90	116	10	90	46	14
5	APSPD₅					
	120	153	10	122	61	18

gruppo - group	piastra inferiore doppia double lower plate					
	APINPD					
	a mm	f mm	s mm	c mm	p mm	m
1	APINPD₁					
	60	74	8	33	31	M10
2	APINPD₂					
	60	86	8	45	31	M10
3	APINPD₃					
	60	100	8	60	31	M10
4	APINPD₄					
	90	140	10	90	46	M12
5	APINPD₅					
	120	180	10	122	61	M16